

ESTATE PLAN

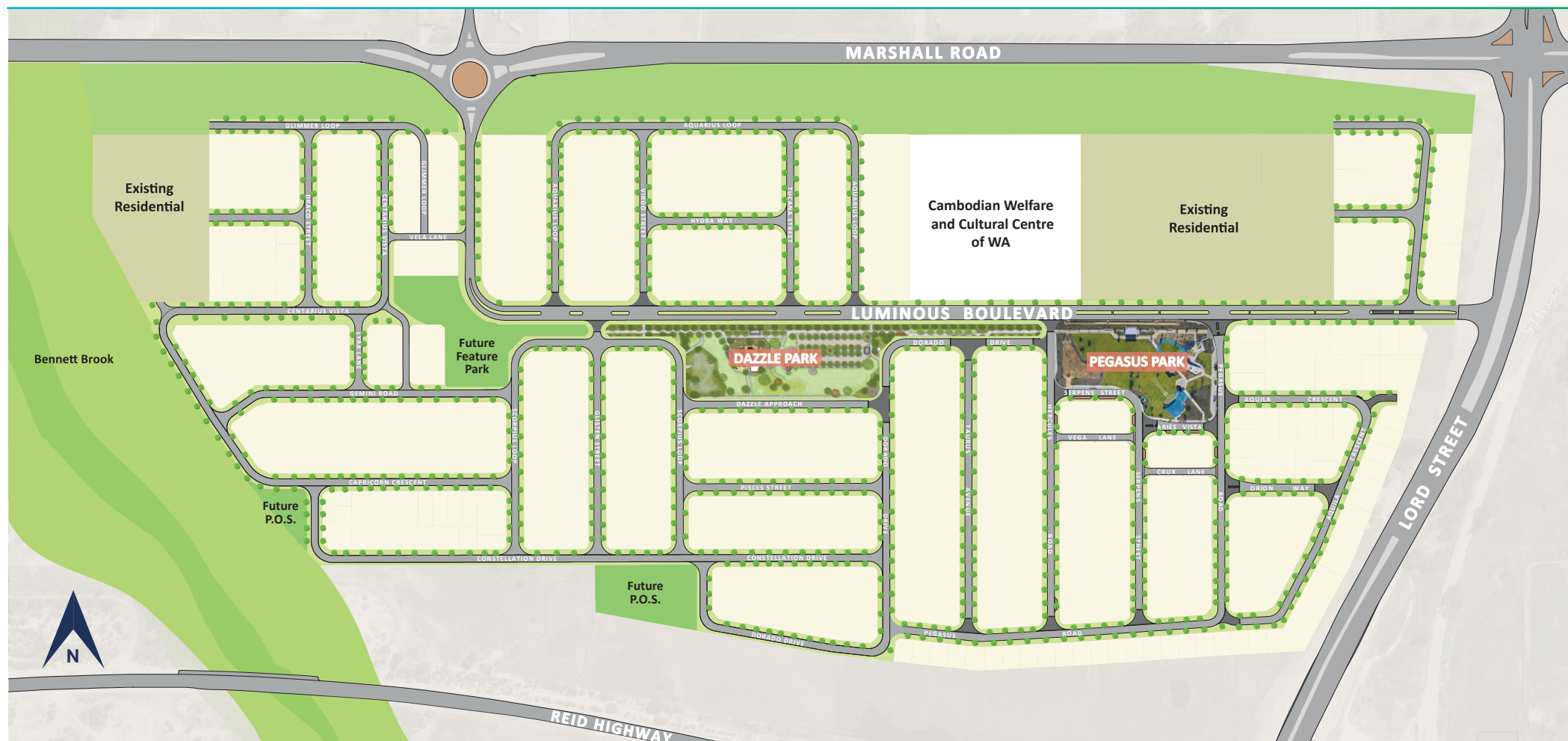

Iluma Sales and Information Centre

Corner of Luminous Boulevard and Pegasus Road, Bennett Springs

w: iluma.mirvac.com t: 9424 9989

The information shown on this plan has been prepared with care, however it is subject to change and cannot form part of any offer or contract other than to identify the lot number and location of the block being purchased. Whilst all reasonable care has been taken to prepare this information, the Seller or its representatives and agent cannot be held responsible for any inaccuracies. Interested parties must be sure to undertake their own independent enquiries. Lot information is subject to survey, Title Office and regulatory approval. Mirvac Real Estate Pty Ltd. Mirvac WA Pty Ltd. Produced August 2019.